



## 190 Haselbury Road

, London, N9 9BL

**£520,000**



Located in a sought-after area of Edmonton, this well-presented 3-bedroom property offers generous living space, featuring two bright reception rooms, a modern bathroom, and a private garden – perfect for families or investors alike.

The home benefits from a well-proportioned layout with plenty of natural light throughout. Situated within close proximity to local amenities including supermarkets, cafes, and the Edmonton Green Shopping Centre, as well as excellent transport links via Edmonton Green Station (Overground) and local bus routes.

Several reputable schools are nearby, making this an ideal location for families. With parks and green spaces also within walking distance, this is a fantastic opportunity to own a home in a well-connected and vibrant community. Don't miss out – contact us today to arrange a viewing!





Area Map



Floor Plans

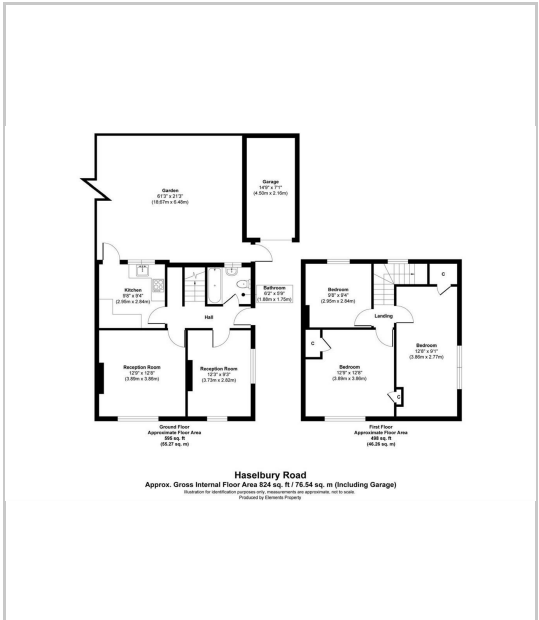

Energy Efficiency Graph

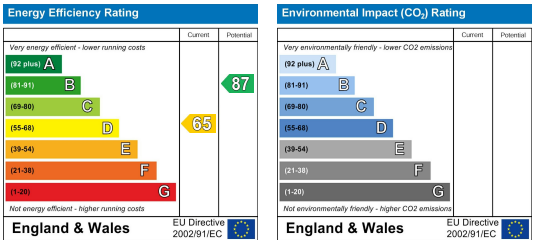

These particulars, whilst believed to be accurate are set out as a general outline only for guidance and do not constitute any part of an offer or contract. Intending purchasers should not rely on them as statements of representation of fact, but must satisfy themselves by inspection or otherwise as to their accuracy. No person in this firms employment has the authority to make or give any representation or warranty in respect of the property.